

Lever handle

Arne Jacobsen Collection

d line

PRODUCT DATA SHEET

ITEM NUMBER 12.4042.01.030
SURFACE Polished brass

PICTURE



PRODUCT

Lever handle AJ 97 mm, brass, pair solid cc 30 mm, 33-59 mm

TENDER TEXT

Lever handle by Arne Jacobsen. Iconic, timeless and classically elegant.
Material: polished brass finish. Pair solid cc 30 mm, 33-59 mm. W:124 mm x H:50 mm x D:80 mm.

PRODUCT SPECIFICATION

Dimensions: W:124 mm x H:50 mm x D:80 mm.

Material: brass

Surface finish: polished

Warranty for brass (non movable) parts - 15 years

DRAWING

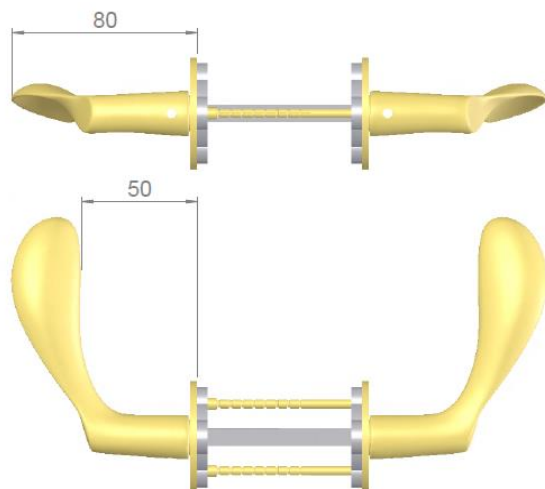

SPARE PARTS / ACCESSORIES:

14.2810.92.092 Spindle 8x8x92
14.9701.02.019 Grub screw M5x8,3 mmde

MOUNTING:

See instruction supplied with the product

PACKING:

1 pcs. In a bag

ISO-DRAWING

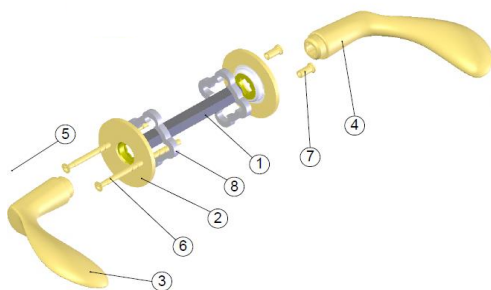

CERTIFICATES & AWARDS

Tested by EN 1906 standard

PRODUCT CARE

d line products are produced from brass. To sustain the unique d line finish appearance please follow the below instructions:

- Wash down the surfaces using soapy water or mild detergent
- Always thoroughly rinse off with clean water
- To complete the cleaning procedure dry/polish the surfaces with a soft dry cloth

Please do not use scouring powder, steel wool, chloride based detergents or other aggressive cleaning products as these may damage the surface.